

LEASEHOLD



Flat (EPC Rating: B)

# FLAT 9 ELLESMERE COURT, STIRLING DRIVE, LUTON, LU2 0GD

Asking price

£260,000

**McLains**  
— ESTATE AGENCY —



# 2 Bedroom Flat located in Luton

Welcome to this stunning executive apartment located in the desirable Ellesmere Court on Stirling Drive, Luton. Built in 2019, this immaculate flat offers a modern living experience with a generous 660 square feet of well-designed space.

As you enter, you will be greeted by a bright and airy reception room that provides a perfect setting for relaxation or entertaining guests. The apartment features two spacious double bedrooms, including a master suite with an en-suite bathroom, ensuring comfort and privacy. The additional bathroom is equally well-appointed, catering to the needs of residents and visitors alike.

One of the standout features of this property is the lovely balcony, which offers a delightful outdoor space to enjoy fresh air and views. The ground floor location adds convenience, making access easy and hassle-free. Furthermore, the apartment comes with a dedicated parking space, a valuable asset in this bustling area.

Mclains Agency is proud to present this exceptional flat, ideal for professionals, couples, or small families seeking a contemporary lifestyle in a vibrant community. With its modern finishes and thoughtful layout, this apartment is not just a place to live, but a place to call home. Don't miss the opportunity to make this exquisite property your own.



Approximate Gross Internal Area  
700 sq ft - 65 sq m

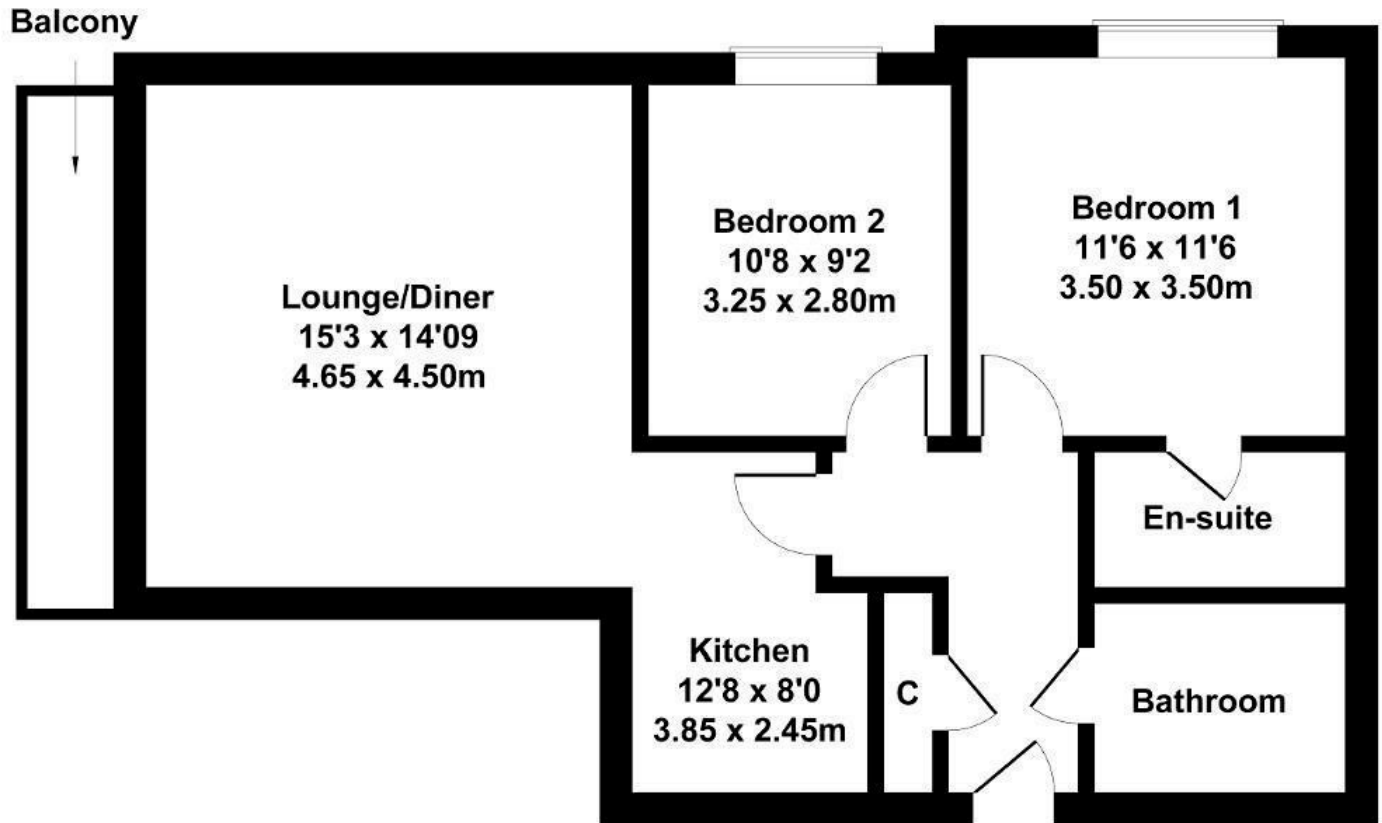

Council Tax Band

**B**

Energy Performance Graph

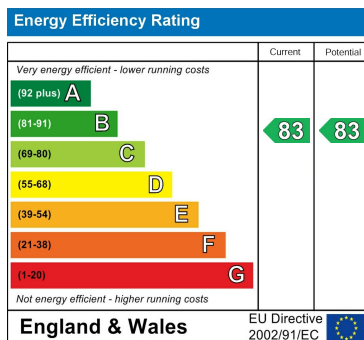

Call us on

**01582 441225**

**info@mclains.co.uk**

**mclains.co.uk**

Agents Note: Whilst every care has been taken to prepare these particulars, they are for guidance purposes only. All measurements are approximate and are for general guidance purposes only and whilst every care has been taken to ensure their accuracy, they should not be relied upon and potential buyers are advised to recheck the measurements.

**McLains**  
— ESTATE AGENCY —